

全国免费服务热线 / Nation Free Tel: **400 8813 578**

DELFA
德尔法电梯



德尔法电梯有限公司
DELFA ELEVATOR CO.,LTD.



本书为一般信息类出版物，我们保留随时更改产品设计和说明的权利。
本书的任何字句，无论其字面意思或含义，对于任何产品及产品的用途和质量，或着任何声称与原文的表述与更改均不承担任何责任。
由于印刷工艺的限制，实际加工的颜色可能与本图略有不同之处，最终以实际材料和色样决定。
It is an ordinary information publication. We keep the right of alter the product design and description at any time.
If there is any dispute out of the literal meaning of any product description, use or quality, the description and alteration any sales contract, our company will not bear any responsibilities therefrom.
Because of the restriction of the printing technology if there is any slight difference between the actually machining color and that from this pamphlet, please take the actual material and color sample as the criterion.

2018.12月份印刷
2018.12 version



HOME ELEVATOR

別墅電梯

德尔法电梯有限公司
DELFA ELEVATOR CO.,LTD.



为爱筑家 享品质生活

Life of high quality with love



住宅别墅
Residential Villa

独具匠心的工艺设计，人性化的智能科技，
为您创造理想的生活方式、更和谐的生活空间。

The perfect integration of modern aesthetics and
architectural design enables you to enjoy ideal life style and have more life space.



About Delfar

关于德尔法

德尔法电梯有限公司坐落于长江三角洲经济区腹地、被称为电梯之乡的浙江湖州，东邻上海，南依杭州，是一家集电梯设计、研发、制造、销售、安装、维保为一体的大型专业化电梯企业。

企业现已通过ISO9001国际质量体系认证、ISO14001环境管理体系认证、OHSAS18001职业健康安全管理体系认证。在与时俱进的创新步伐中，引进全球先进的生产设备，实现先进管理方式的深层次转变，并不断在智能化领域深耕，致力于打造未来的智慧工厂。目前产品已涵盖乘客电梯、观光电梯、病床电梯、家用电梯、载货电梯、汽车电梯、小机房电梯、无机房电梯、自动扶梯和自动人行道等系列产品。

企业站在打造百年基业的高度，一直以“自主创新”为核心，不断攀登新的技术高峰，设立技术研发中心，坚持产学研合作的研发模式，不断将自主创新成果推向市场，为技术和人才创新的可持续发展打下坚实的基础。

德尔法电梯将始终秉承“诚信经营、不断进取、奉献社会”的经营理念，风雨携手，共赴辉煌。执行企业长期性的战略发展规划，通过实施品牌战略、人才战略、文化战略、管理战略、国际化战略、信息化战略等，铸就企业核心优势，努力实现振兴民族品牌的梦想。

Delfar Elevator Co., Ltd. is located in Changjiang River Delta Economic Area Hinterland Huzhou, Zhejiang, China, which has been reputed as "Hometown of Elevator". It is close to Shanghai in the east, to Hangzhou in the south. It is a large size specialized elevator enterprise that integrates the elevator design, research, development, manufacture, sales, installation, repair and maintenance into one.

At present, the enterprise has passed ISO9001 International Quality System Certification, ISO14001 Environment Management System Certification, OHSAS18001 Occupational Health Safety Management System Certification. Along with the innovative steps which keeps abreast with the times, it introduces the advanced international production equipment, fulfills in-depth transformation of advanced management mode. It keeps researching into and developing the intellectual field. It is engaged in constructing future intellectual factory. At present, the products cover passenger elevator, observation elevator, hospital elevator, home elevator, freight elevator, automobile elevator, small machine room elevator, machine room-less elevator, escalator, moving walk series etc.

Standing at a height of building up a centennial career, it is always cored by "independent innovation". It keeps climbing new technical peaks. It sets up "Technical Research & Development Center". It sticks to the research and development mode of production-study-research cooperation. It continuously puts out individual innovation fruits to the markets. It lays a solid foundation for sustainable development of technological and talent innovation.

Delfar Elevator will, as always, adhere to the management ideas of "sincere & creditable management, keep charging, pay contribution to our societies". Let's join hands in order to together creating great splendors. It executes the long-term enterprise strategic development plans. It founds core business advantages through carrying out brand strategy, talent strategy, culture strategy, management strategy, internationalized strategy, information strategy etc. It strives to fulfill the dream of vitalizing a famous national brand.

Advanced technology

先进技术

永磁同步无齿轮曳引机

运用成熟的永磁同步无齿轮曳引技术，提高了建筑利用率，提升了电梯驱动性能，方便您享受别墅生活。



全电脑智能型控制系统

多微机、模块化、网络化的控制系统，高效处理数据，电梯运行系统更稳定、更精确、更可靠。



220V节能新家电

220V常规电压，1.1KW超低能耗，专属于您的安全、节能“新家电”。

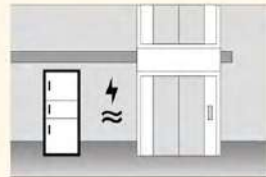

Permanent magnet synchronous gearless traction machine

It applies mature permanent magnet synchronous gearless traction machine, which improves building utilization rate and enhances elevator's driving performance, so that you can enjoy a comfortable life.

Full-computer intelligent control system

Multi-microcomputer, modularized and networked control system along with high-efficiency data processing drives elevator operation system more stable, accurate and reliable.

220V energy-saving new appliance

220V conventional voltage, 1.1 KW ultralow energy consumption, exclusive to your safety, energy-saving "new appliance"

平稳上下，舒适到家

VVF变频变压调速技术，智能化精准数据，实现平缓加减速；采用平滑运行曲线，依据人体感官反应，提升乘行舒适度。

Stable travel up and down, carry comfortable to home

VVF frequency and transformer speed adjust technology, and intelligent accurate statistics, to realize stable speed change; Apply smooth travel route, and according to people sensor responses, to increase the comfort of traveling

绿色动力

采用稀土永磁同步无齿轮主机（高效PM永磁同步无齿轮主机），没有碳刷，不产生炭灰；内置式碟型制动器使运行更加安全、可靠；体积比相同负载下的传统主机小70%；永久密封轴承无需油脂润滑，保证机房清洁；摩擦系数更高的复合钢带，有效的将主机动力传递到轿厢，提高运行效率，比传统有齿轮主机更加节能。

Green power

It applies rare earth permanent magnet synchronous and gear-less machine (effective PM permanent magnet synchronous & gear-less machine) without carbon brush. It thus does not produce carbon ash. Internal disc type brake brings about the more secure and reliable operation. Its bulk is 70% smaller than traditional machine under same load. Permanently sealed bearing needs no grease lubrication. It ensures a clean machine room with the higher frictional coefficient composite steel belt. It effectively transfers machine motives to elevator car. Therefore, it enhances the running efficiency. It saves more energy than traditional geared machine.

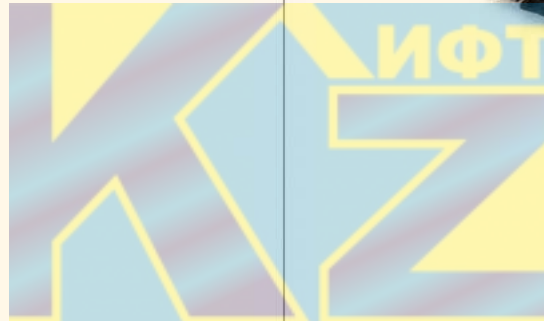

Comfortable experience

舒适体验

改善运行体验

德尔法别墅电梯钢带采用表面聚氨酯层，减少传统钢丝绳与主机（金属）之间的摩擦。有效降低运行中的震动和周边环境噪音，为客户创造更舒适更安静的移动空间。

Improve operation experience

Delfar home elevator steel belt applies surface polyurethane PU layer. It reduces friction between traditional wire rope and machine (metal). It effectively reduces vibration, surrounding noise during the operation. It creates a more comfortable and peaceful mobile space for extensive clients.

提升乘客舒适感

德尔法别墅电梯无齿轮主机带有一个复杂的称重装置和矢量闭环的变频驱动，从而给乘客带来平稳、安静的体验，而且保证每层的停层精度控制在 $\pm 10\text{mm}$ 。

钢带检测装置

钢丝绳表面的断裂情况会造成电梯停机，传统的钢丝绳检测依靠于用人的肉眼检查钢丝绳表面的断裂数。德尔法电梯钢带检测装置，检测钢带的金属疲劳或股损坏。在维保和顾客未察觉的情况下，可以提前预警，保证及时更换。

Improve passenger comfort

Delfar home elevator gear-less machine has a complicated weighing device and variable frequency drive of vector closed-loop. It thus provides vast passengers with smooth and peaceful travel. Furthermore, it guarantees that parking accuracy at each floor is controlled within $\pm 10\text{mm}$.

Steel belt detection device

Broken wire rope stops the elevator. Traditional wire rope detection relies on checking the broken number of wire rope by human eyes. Delfar elevator steel belt monitoring device detects metal fatigue or strand damage of steel. Under the conditions that passengers / repair & maintenance staff are not aware of any damage, it makes alarm in advance and ensures prompt renewal.



Applicable occasion and human-oriented design

适用场合及人性化设计

德尔法别墅电梯根据建筑空间结构和个性化需求，为客户量身设计专属您的私享空间，大大提高空间利用率，同时美化建筑环境。

Delfar home elevator provide a custom design of your private space based on architectural space structures and individual requirements, which better improves space utilization and beautify building environment.



多种安装方式 Multiple installation modes

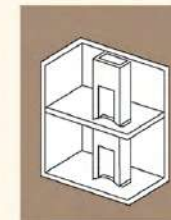

① 楼房有专用电梯井道
Dedicated hoistway inside

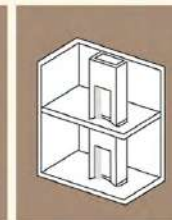

电梯可以直接安装在专用井道内
Installed in the dedicated hoistway

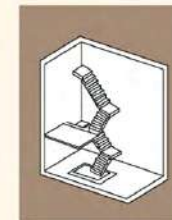

② 环绕楼梯中间有合适空间
Circular staircases

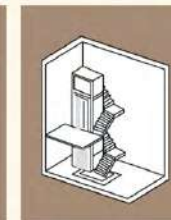

在中间加装井道安装电梯
Installed inside the newly-built hoistway surrounded by the staircases

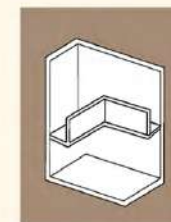

③ 有中空的大厅或房间
Hollow hall or room

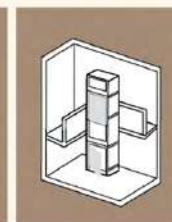

在大厅或房间加装井道安装电梯
Installed inside the newly-built hoistway in the hall or room

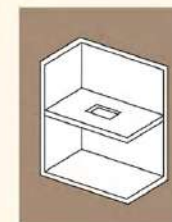

④ 楼房内没有合适空间
电梯只能安装在室内
No dedicated hoistway inside and no suitable space in the building

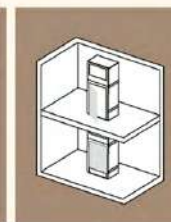

在楼板开出合适的孔
加装井道安装电梯
Installed inside the newly-built hoistway through the ceiling

②③④⑤场合需要加装电梯使用的井道，客户也可以自己采用金属框架或混凝土等材料预先建立井道。

②③④⑤ occasions need to install the shafts. Customers can also use materials such as a metal framework or concrete to build the shaft beforehand.

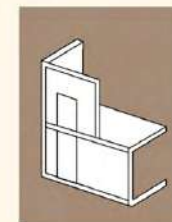

⑤ 楼房内没有合适空间
No suitable room inside

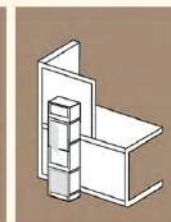

在允许情况下，在室外
加装井道安装电梯
Installed outside with the newly-built hoistway if allowable

Internet + elevator high-end brand

“互联网+电梯” 高端品牌

产业升级

德尔法电梯引领传统电梯产业升级，借助互联网信息技术的发展，重塑产业新形态，促使互联网深度融合传统电梯产业。

颠覆品牌

德尔法电梯在中国及市场将全面实施“互联网+”的运营策略，颠覆市场品牌认知，为您提供更安全、更高效、更舒适的电梯乘坐空间。

Industrial upgrading

Delfar Elevator leads industrial grading of traditional elevator, rebuilds new industrial shape with development of Internet information technology, promoting the deep integration of internet and traditional elevator industry.

Overturn brand

Delfar Elevator will comprehensively implements "Internet +" operation strategy at home and abroad. It overturns brand recognition in the market, providing you with safer, more efficient and comfortable elevator riding experience.

互联网+智能 Internet + smart

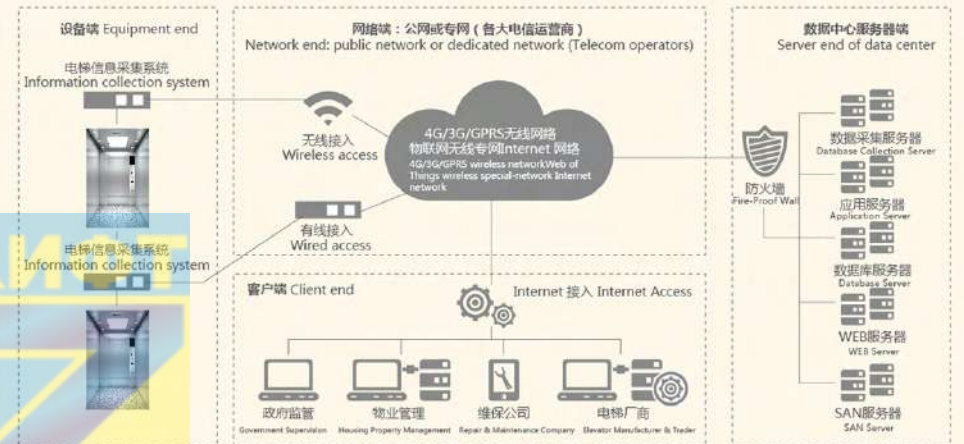
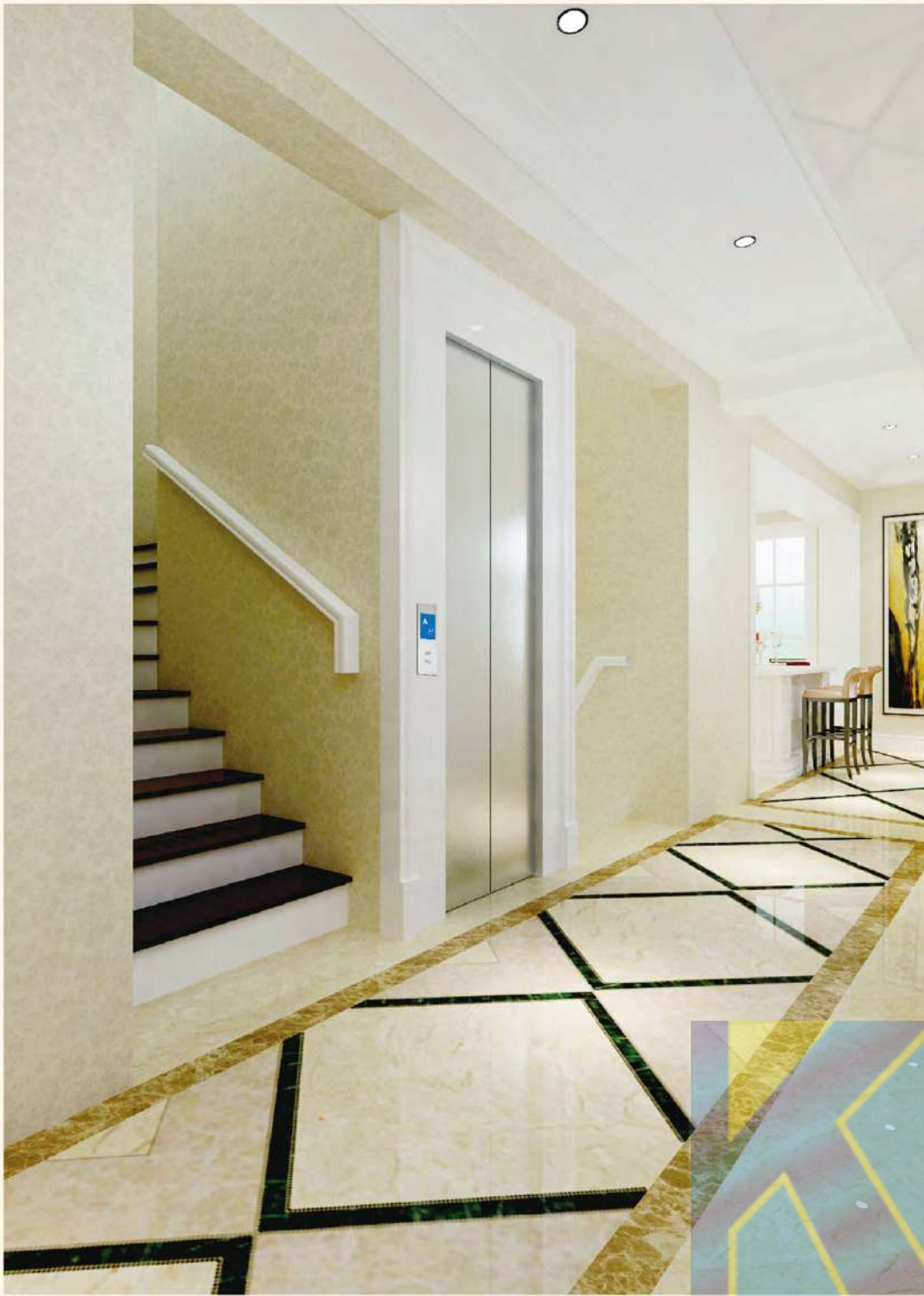

Car frame type structure home elevator

龙门架结构别墅电梯

即国际上的第五代电梯，轿厢的两根轨道位于轿厢两侧，轿厢两侧受力均衡，因而几乎没有导轨摩擦的声音，运行时更平稳，乘坐舒适感更完美，且使用寿命更长。

It is called the fifth generation's elevator internationally, two tracks of cars are located on two sides of the cars. Stresses of cars' two sides are balanced, hence there is nearly no noise of tracks' friction. It is more stable during operation. You will feel perfectly comfortable. In addition, the life length of the elevator is longer.

龙门架结构的特点：

曳引龙门架式家用电梯因为两根导轨分别位于轿厢两侧，就好比两人抬轿一样，轿厢两侧受力是均匀的，轿厢的运行感觉更平稳，有利于延长电梯寿命。

Characteristics of car frame type structure:

Because two rails are located on both sides of the car, it is like two people lifting a sedan. The force on both sides of the car is even and the operation is more stable, which is beneficial to extend the service life of the elevator.



Backpack L shape type structure home elevator

背包架结构别墅电梯

背包架结构别墅电梯顾名思义就像学生背包，对重及轿厢导轨位于轿厢的同一侧，对电梯井道要求低。

The backpack L shape type structure home elevator is just like the student's backpack, the counterweight and the car guide rail are located on the same side of the car, and this type has less requirements to the shaft.

背包架结构的特点：

背包式结构家用电梯，主要针对家庭内较窄并且特深的井道，同时，这种结构的家用电梯也是90°角双轿门电梯的不二选择。

Characteristics of backpack L shape type structure:

The backpack L shape type structure home elevator is mainly for narrow and deep wells in the house. At the same time, this structure is also the best choice for 90 degree adjacent car door.



Steel belt type home elevator

钢带式别墅电梯

德尔法别墅电梯采用更加节能、环保、耐用的复合钢带，配以高效节能型主机、变频门机、安全可靠的光幕门保护装置等多项国际领先技术，将垂直运输电梯发展带入了新的阶段。

Delfar home elevator brings the development of vertical transport elevator into a new stage through more energy-saving, environment-friendly and durable composite steel belt, as well as multiple leading international technologies such as effectively energy-saving machine, variable frequency door machine, safe and reliable light curtain door protection device and etc



与传统钢丝绳相比：

1. 聚氨酯材料层，无需润滑
2. 寿命是传统钢丝绳2-3倍
3. 更易弯曲，增大与驱动轮接触面积，更节能，更高效

Compared with the traditional wire rope:

1. Polyurethane (PU) material layer without lubrication.
2. Its life is two or three times higher than that of traditional wire rope.
3. It is more flexible. It increases the contact areas with drive wheel. It is more effective and energy-saving.



传统钢丝绳
Traditional wire rope



复合钢带
Composite steel belt

Drum type home elevator

强制式驱动别墅电梯

采用强制式结构，无对重将井道利用率扩大至最大化，解决其他机型因井道过小而无法完成设计的困扰。

主机采用新一代强制驱动同步主机，噪音小，节能环保，顶层高度和底坑深度及井道利用率达到了最佳效果。

It is used to maximize the utilization ratio of the well without counterweight, and solve the problem that other types of machines can not complete the design due to the small well path.

The main engine adopts a new generation of forced driving synchronous machine, which is energy-saving and environment-friendly with low noise. Thus overhead height, pit depth and shaft utilization ratio are made fullest use of.

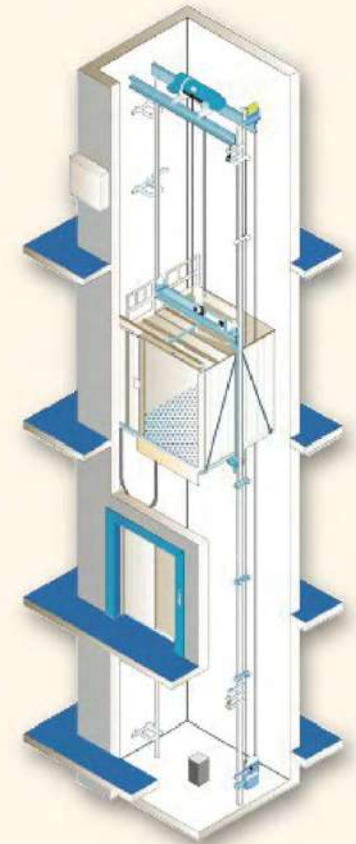

Home elevator car decoration

别墅电梯轿厢装潢



D18128

标配/Standard

吊 顶：D58056 (镜面不锈钢, 亚克力透光板, LED筒灯)

轿 壁：两侧壁, 前壁及后壁辅助板发纹不锈钢, 后壁中间板镜面不锈钢

扶 手：无

地 板：PVC (D61065)

Ceiling: D58056 (Mirror st.st., acrylic light-emitting panel, LED down lamp)

Car wall: Two side walls, front wall and rear wall auxiliary panel Hairline st.st., rear wall central panel Mirror st.st.

Handrail: None

Floor: PVC (D61065)

D18629

选配/Optional

吊 顶：D58062 (钛金镜面不锈钢框架, 亚克力灯饰, LED筒灯)

轿 壁：两侧壁, 前壁及后壁辅助板钛金发纹不锈钢,

后壁中间板钛金镜面不锈钢

扶 手：无

地 板：大理石/PVC (D62066)

Ceiling: D58062 (Ti-gold mirror st.st. frame, acrylic light decoration, LED down lamp)

Car wall: Two side walls, front wall and rear wall auxiliary panel

Ti-gold hairline st.st., rear wall central panel Ti-gold mirror st.st.

Handrail: None

Floor: Marble / PVC (D62066)



D18930

选配/Optional

吊 顶：(D58063) 烤漆木板(象牙白), LED灯, 云石板

轿 壁：烤漆木板(象牙白), 美容镜

扶 手：无

地 板：大理石/PVC (D62067)

Ceiling: (D58063) Baked enamel wooden board(ivory white), LED light, stone

Car wall: Baked enamel wooden board(ivory white), cosmetic mirror

Handrail: None

Floor: Marble / PVC (D62067)



Home elevator car decoration

别墅电梯轿厢装潢



D18531

选配/Optional

吊 顶：D58060 (玫瑰金镜面不锈钢框架，亚克力透光板，LED筒灯)

轿 壁：后壁中间板玫瑰金镜面蚀刻不锈钢，辅助板玫瑰金镜面不锈钢；侧壁中间板皮革硬包，辅助板玫瑰金镜面不锈钢；前壁玫瑰金镜面不锈钢

扶 手：无

地 板：大理石/PVC (D62068)

Ceiling: D58060 (Rose-gold mirror st.st. frame, acrylic light-emitting panel, LED down lamp)

Car wall: Rear wall central panel rose-gold mirror etched st.st. auxiliary panel rose-gold mirror st.st.; side wall central panel leather hard-roll, auxiliary panel rose-gold mirror st.st.; front wall rose-gold mirror st.st.

Handrail: None

Floor: Marble / PVC (D62068)

D18932

选配/Optional

吊 顶：D58065 (木质饰面，内嵌钛金镜面装饰条，四周暗藏柔和光源，中间高档装饰条)

轿 壁：后壁中间板木质造型框内嵌木饰面，钛金镜面蚀刻不锈钢，辅助板钛金镜面不锈钢；侧壁中间板是木质造型框，钛金镜面不锈钢，辅助板木饰面；前壁木饰面

扶 手：无

地 板：柚木地板 (D63070)

Ceiling: D58065 (Wooden decoration inlaid with Ti-gold mirror decoration strip, four side hidden light source, central part high grade decoration strip)

Car wall: Rear wall central panel wooden model frame inlaid with wooden decoration, Ti-gold mirror etched st.st., auxiliary panel Ti-gold mirror st.st.; side wall central panel wooden model frame, Ti-gold mirror st.st., auxiliary panel wooden decoration; front wall wooden decoration

Handrail: None

Floor: Teakwood floor(D63070)



D16933

选配/Optional

吊 顶：D58066 (镜面不锈钢，LED灯饰)

轿 壁：后壁及一侧壁发纹不锈钢边框观光玻璃，另一侧壁木饰面化妆钢板，前壁发纹不锈钢

扶 手：D77007 (钛金不锈钢圆扶手，中间实木)

地 板：大理石/PVC (D62069)

Ceiling: D58066 (Mirror st.st., LED light decoration)

Car wall: Rear wall and one side wall observation glass with hairline st.st. frame, one side wall wood grain decoration make-up steel plate, front wall hairline st.st.

Handrail: D77007(Ti-gold st.st. round handrail, central part solid wood)

Floor: Marble / PVC (D62069)





Operation panel series

操纵箱系列



D36378

标配/standard



D35251



D38201

选配/Optional



D37202



D38203

选配/Optional



D37205



D38206

选配/Optional



D37207



D36196

选配/Optional



D38108

选配/Optional

按钮系列
Button series



DB01
标配/Standard



DB02
选配/Optional



DB03
选配/Optional

Landing door series

厅门系列



D20128
有框玻璃门，发纹不锈钢框架
Glass door with hairline st.st.frame



D20526
镜面蚀刻不锈钢
Mirror etched st.st.



D20530
镜面蚀刻不锈钢
Mirror etched st.st.



D20710
钛金镜面蚀刻不锈钢
Ti-gold mirror etched st.st.



D20727
钛金镜面蚀刻不锈钢
Ti-gold mirror etched st.st.



D20729
玫瑰金镜面蚀刻不锈钢
Rose-gold mirror etched st.st.

Ceiling series

吊顶系列



D58056 标配/Standard
镜面不锈钢，亚克力透光板，LED筒灯
Mirror st.st., acrylic light-emitting panel, LED down lamp



D58057 选配/Optional
镜面不锈钢，亚克力，LED筒灯
Mirror st.st., acrylic, LED down lamp



D58058 选配/Optional
不锈钢框架，亚克力拱顶，两侧LED灯
St.st. frame, acrylic arch, LED lamps on both sides



D58059 选配/Optional
钛金镜面不锈钢框架，亚克力透光板，LED筒灯
Ti-gold mirror st.st. frame, acrylic light-emitting panel, LED down lamp



D58060 选配/Optional
玫瑰金镜面不锈钢框架，亚克力透光板，LED筒灯
Rose-gold mirror st.st. frame, acrylic light-emitting panel, LED down lamp



D58061 选配/Optional
木质造型顶，亚克力，LED筒灯
Wood moulded roof, acrylic, LED down lamp

Handrail series 扶手系列



D77102
发纹不锈钢扁扶手
Hairline st.st. flat handrail



D77103
钛金发纹不锈钢扁扶手
Ti-gold hairline st.st. flat handrail



D77005
发纹不锈钢圆扶手
Hairline st.st. round handrail



D78006
发纹不锈钢圆扶手
Hairline st.st. round handrail



D77007
钛金发纹不锈钢圆扶手，中间实木
Ti-gold hairline st.st. round handrail,
central part solid wood



D77009
钛金镜面不锈钢圆扶手
Ti-gold mirror st.st. round handrail

Floor series 地板系列



D61001



D61002

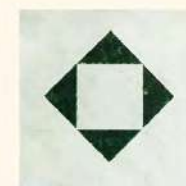

D61011



D61059



D61060



D61061



D61062



D61063

Painted steel color 喷涂钢板色块



RAL7032
卵石灰
Pebble gray



RAL7038
玛瑙灰
Agate gray



RAL6019
松蓝绿
Pastel green



RAL9010
白色
White



RAL1013
白浅灰
White gray

● 图片系电脑绘制，可能与实际略有不同。
The pictures are plotted by computer and are likely somewhat different from the actual products.

Perfect function

完美功能

安全功能 \ Safety function

故障检测与救援 Fault detect & rescue

电机过热保护 S
Motor overheat protection

故障自动检测功能 S
Fault self-diagnosis

变频器过热保护 S
Inverter overheat protection

过电流保护 S
Overcurrent protection

过负载保护 S
Overload protection

逆向运行保护 S
Reverse operation protection

打滑保护 S
Slip protection

过行程保护 S
Overrun protection

主回路故障保护 S
Main circuit fault protection

门受阻保护 S
Door block protection

出入口光幕保护 S
Entrance & exit light curtain protection

安全回路保护 S
Safety circuit protection

换层停靠功能 S
Change landing floor

停电恢复自动校正 S
Automatic adjustment after power recover

断电自动平层 O
Leveling when power failure

电话报警救援 O
Rescue by telephone call

运行次数累计 S
Running times counting

乘客舒适功能 \ Comfortable function

出入轿厢 Into/go out of cabin

开门按钮 S
Door open button

关门按钮 S
Door close button

光幕保护 S
Light curtain protection

滥用/误用保护 Misuse protection

双击按钮取消错误内呼 S
Cancel call by double click

反向内呼 S
Call for the other direction

运行舒适度 Operating comfort

轿内照明 S
Illumination in cabin

轿内风扇 S
Ventilation in cabin

到站提示 S
Arrival indication

优化的运行曲线 S
Optimized operation curve

背景音乐/语音报站 O
Background music/voice announcer

特殊功能 Special function

残障功能(盲文按钮, 语音提示) O
Handicapped function (button in Braille & voice announcement)

贯通门控制 O
Opposite door control

可选楼层停靠/开门功能 O
Selective landing floor

残疾人开门保护 O
Handicapped door open protection

控制功能 \ Control function

自动门 S
Automatic door opening

开关门时间调节 S
Adjustable door open time

检修运行 S
Inspection operation

测试运行 S
Test operation

无呼返基站 S
Auto home

故障记忆 S
Fault memory

井道自学习功能 S
Shaft information self learning

信息功能 \ Information function

厅外信息显示 Information at landing

运行方向显示 S
Running direction display

轿厢位置显示 S
Car position display

呼梯登记指示 S
Indication of registered call

故障警示 S
Fault warning

轿内信息显示 Information in cabin

内呼登记显示 S
Indication of registered call

运行方向显示 S
Runing direction display

楼层显示 S
Floor number display

超载警示 S
Overload warning

故障警示 S
Fault warning

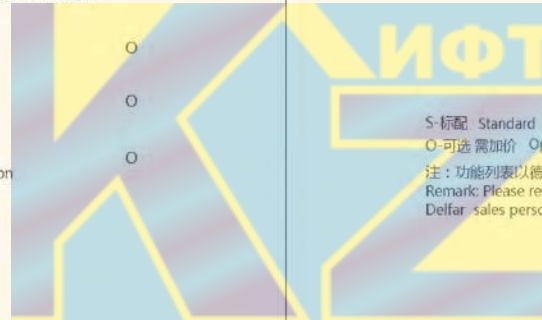

S-标配 Standard
O-可选 需加价 Optional

注: 功能列表以德尔法技术文件为准, 详情请洽德尔法当地销售代表。
Remark: Please refer to Delfar technical documents and contact our Delfar sales person for details.